

FAST
TEST



Bio-FAST LLC

www.bio-fast.com

info@bio-fast.com

Canine Brucella Antibody



BF-CBAT-15
15 TESTS



Kit Components

- 15 Test Cassettes
- 15 Assay Diluents
- 15 Disposable Pipettes
- 1 Instruction Manual

Storage

- Store the test kit at 2-30°C.
- DO NOT FREEZE.
- Avoid storing the test kit in direct sunlight.
- The test kit remains stable until the expiration date indicated on the package label.

Samples

- Use Canine whole blood, Serum or plasma.
- For Serum: Collect whole blood in a tube without anticoagulant. Let it sit at room temperature for 30 minutes, then centrifuge to separate the serum.
- For Plasma: Collect whole blood in a tube with anticoagulant, then centrifuge to obtain the plasma.
- For Whole Blood: Collect blood into anticoagulant tube and use it directly without further processing.

Precautions

- This kit is intended for brucellosis antibody detection in serum, plasma & whole blood. Ensure you fully understand its intended use.
- Carefully inspect the kit package and read the instructions to confirm the kit's validity and intact packaging. Only use valid kits.
- If any damage or leakage is detected, contact your vendor for a replacement. Do not use the kit unless otherwise agreed by the vendor.
- Handle all collected samples carefully, as they may be contagious, following local laws and regulations.
- Used test kits and tested samples should be handled carefully to avoid further contamination.
- Use the test cassette within 5 minutes after opening the foil package. Do not open without a planned experiment.
- Do not use components from other sources, as this will invalidate the results.
- The kit is designed for single use; do not reuse it.



Test Procedure



1. The assay buffer and the sample should be at room temperature before testing.
2. Remove the test cassette from the bag and put it on flat surface.

3. Collect the sample using the disposable pipette and add 1 drop into the sample well of the test cassette.

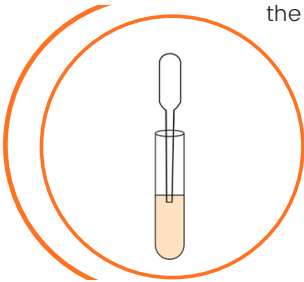

4. Add 3 drops of the assay diluent into the sample well vertically.

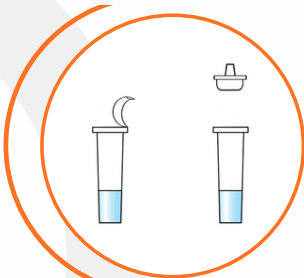
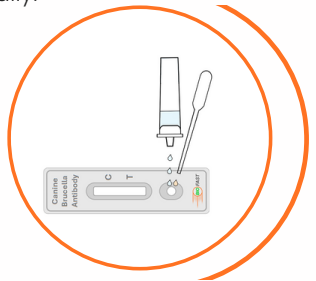

5. Read the results after 15 minutes.

Note: Results observed after 15 minutes will be invalid.

Result Interpretation



Negative Result

("C") Line: Dark

("T") Line: Absent

Absence or undetectable levels of brucella antibodies.



Positive Result

("C") Line: Dark

("T") Line: Dark

Presence of brucella antibodies in the sample.



Invalid Result

("C") Line: Absent & ("T") Line: Absent

("C") Line: Absent & ("T") Line: Dark

The sample should be re-tested.



Limitations

- The kit is designed for screening purposes and on-site testing.
- A positive result from this kit must be further confirmed by PCR and/or other official methodologies.
- Veterinarians should consider the clinical symptoms and laboratory results to make the final diagnosis.